

FLARE See Through 25

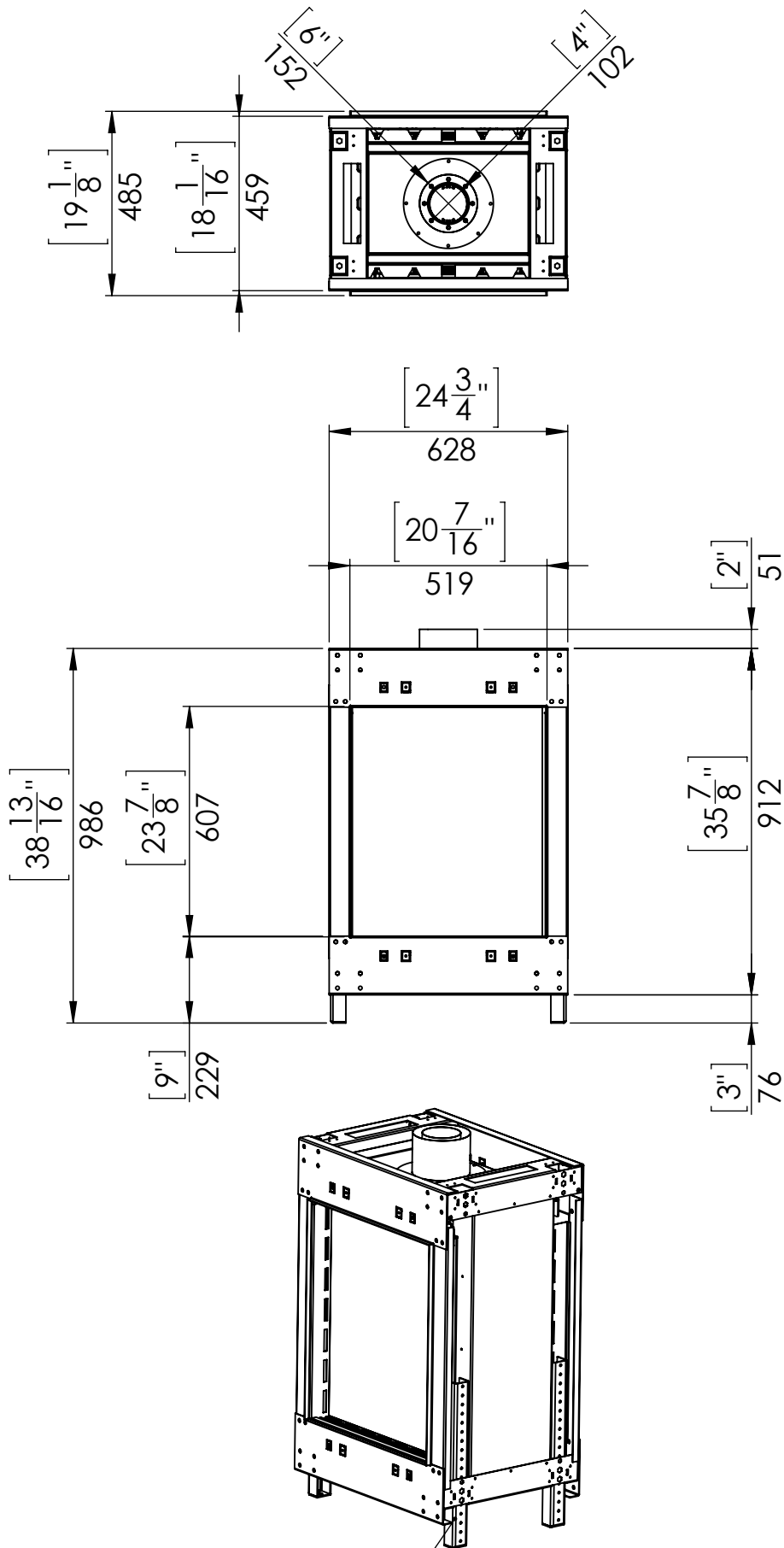

Telescopic Leg Range
(from bottom of glass):
9" - 19"

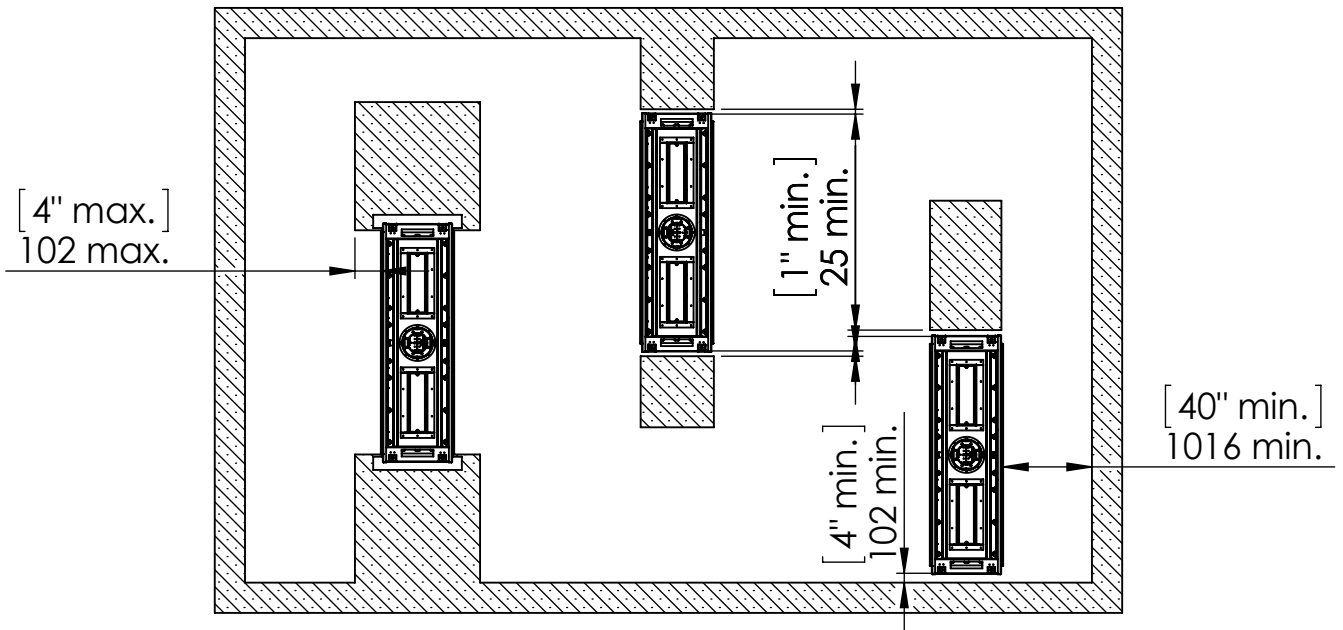

Chimney Installation

Horizontal Termination

For 4 x 6 vent size create 8" x 10" vent termination opening

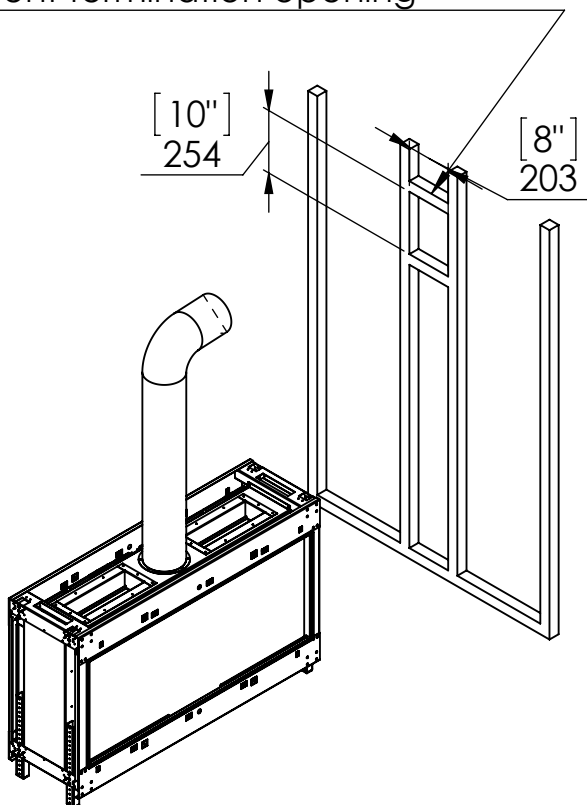

Vertical Termination

For 4 x 6 vent size create 8" x 8" vent termination opening

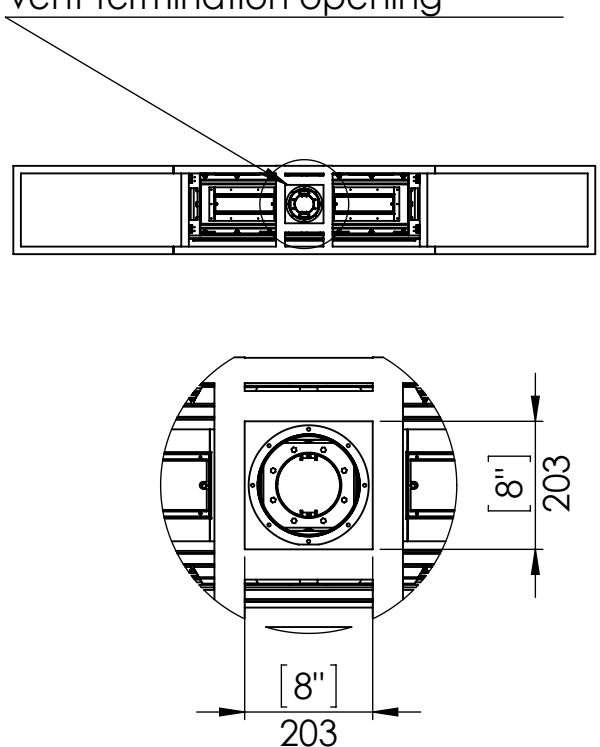

Flat Installation

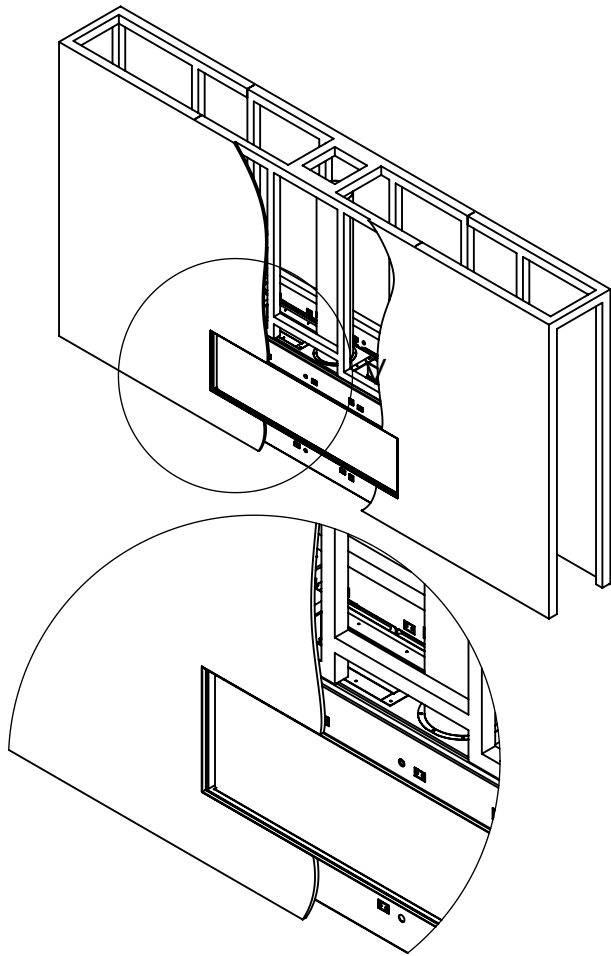

L Shape Installation

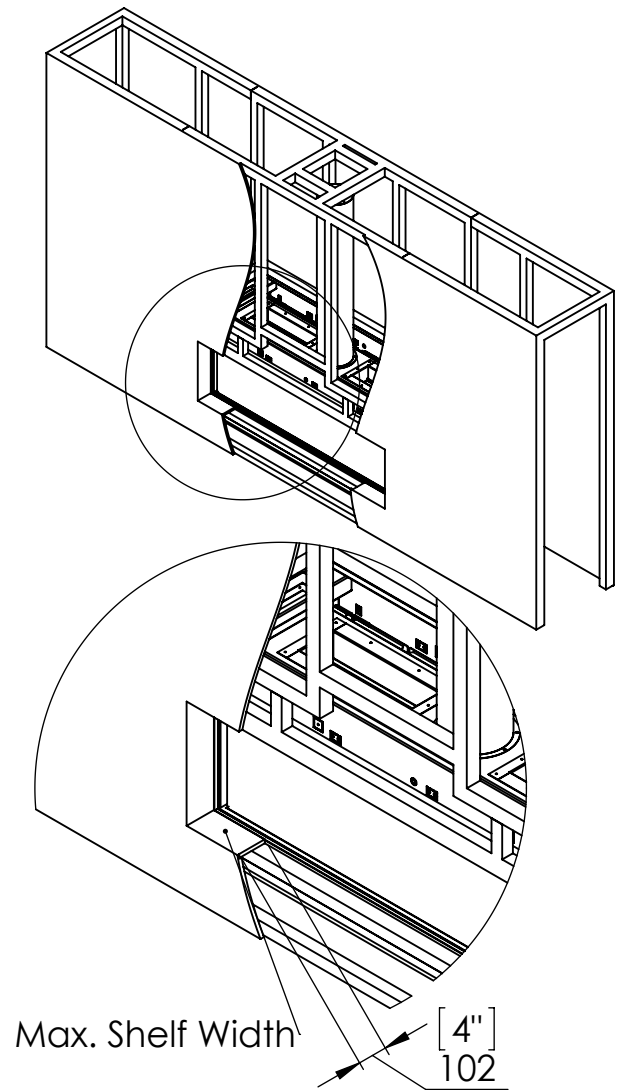

Step 1 - Basic Framing :

Step 1 - Basic Framing :

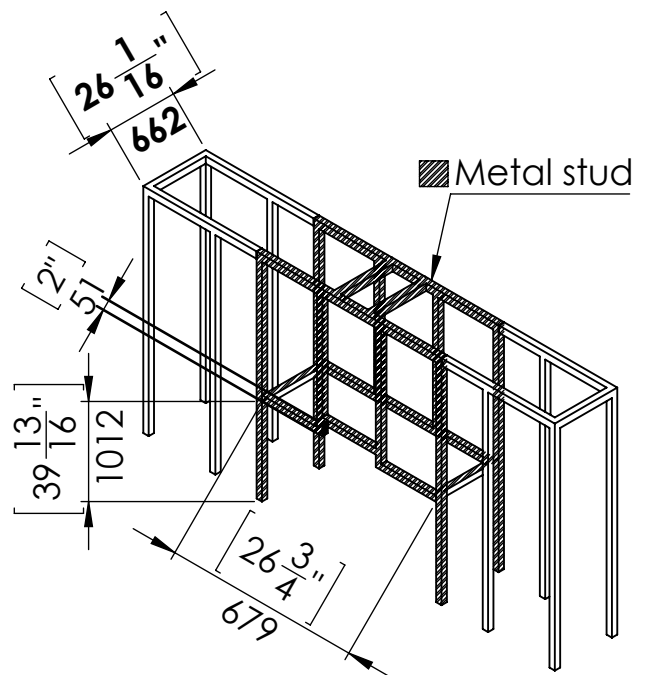
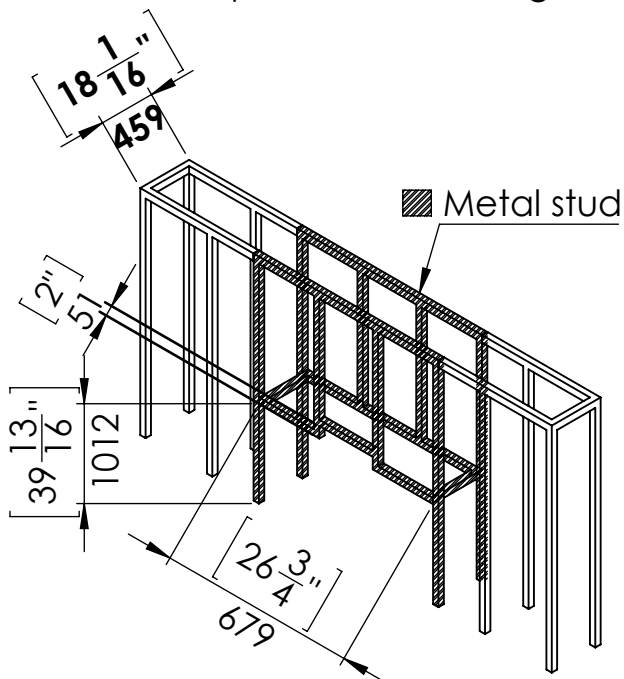

Flat Installation

Step 2 -Positioning the Fireplace:

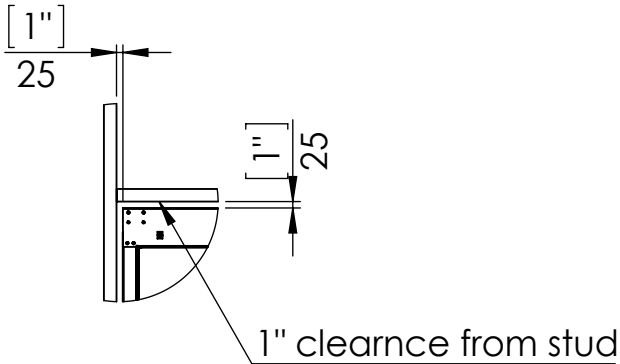
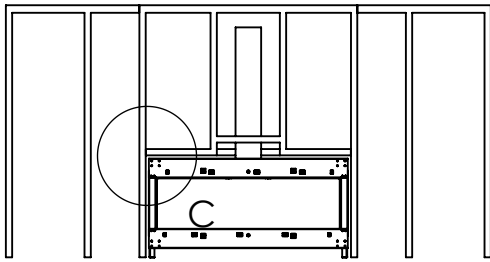
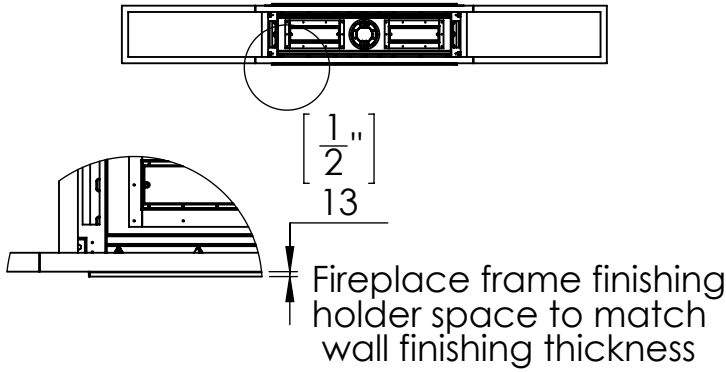

Last Step - Finishing The Fireplace Wall:

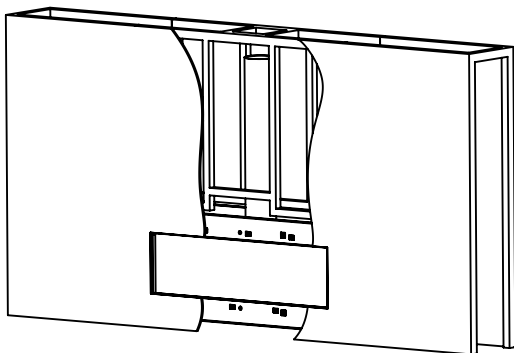

L Shape Installation

Step 2 -Positioning the Fireplace:

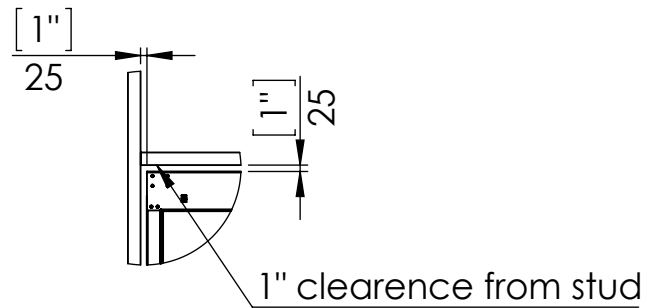
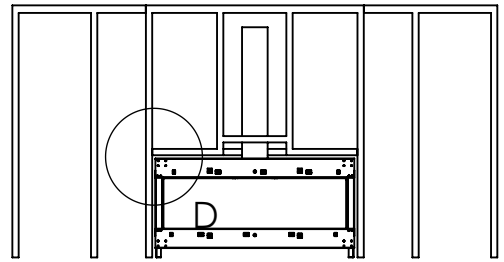
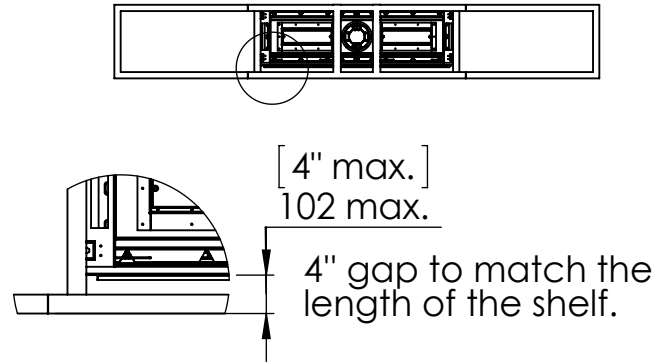

Step 3 - Framing Front Studs For L Shape:

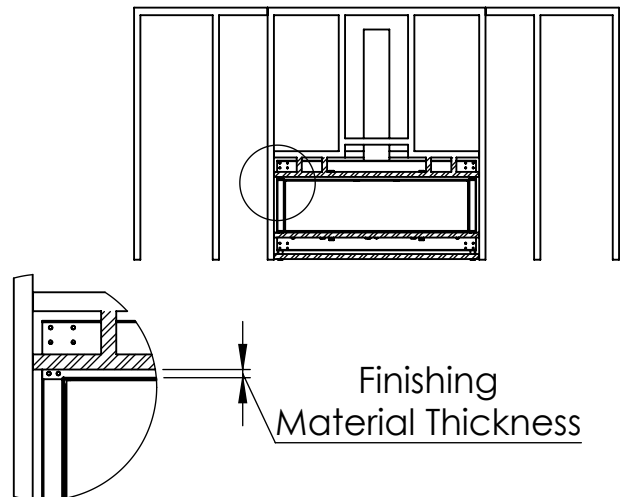

L Shape Finishing Install

Last Step - Finishing The Fireplace Wall:

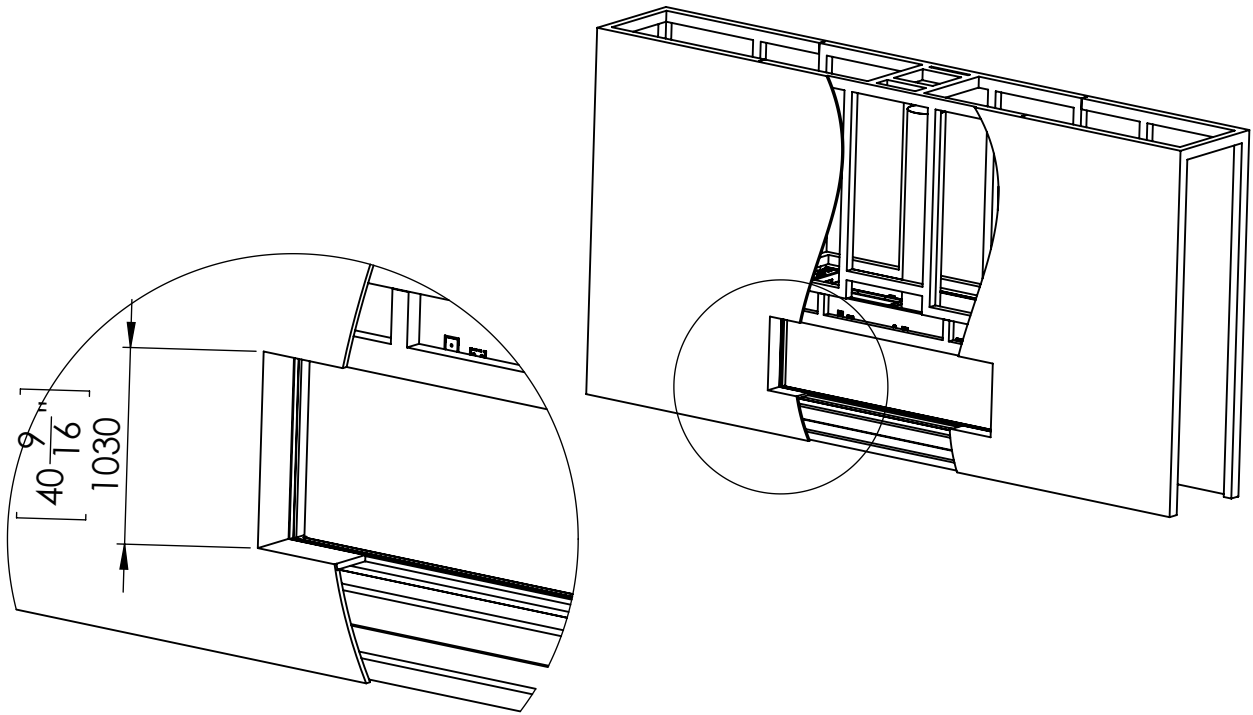

Specifications for Appliance Flare See Through 25

Factor	NG	LPG
Burner Type	35	35
Orifice	650	220
BTU Max.	30000	20000
BTU min.	17500	12500
Kw/h	8.8k	5.9k
Chimney DIA.	4X6	4X6
Manifold Pressure[w.c]	5.4	8.0
Efficiency rate	81	77
Glass Size Length\Width	500 X 620 mm	19" 11/16 X 24" 9/16'
Appliance Weigh	80Kg	176lb