

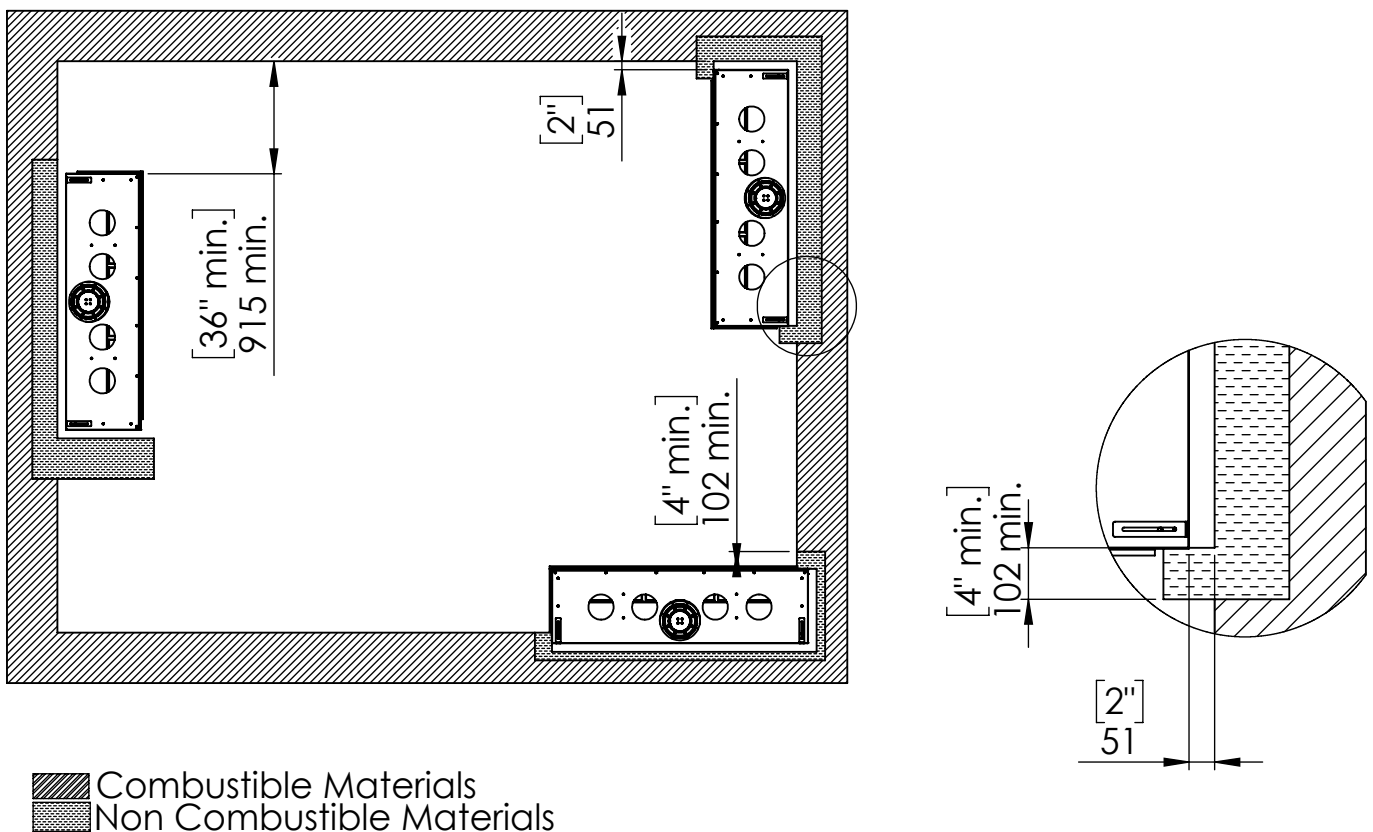

# Specifications for Appliance Flare Right Corner 45H

Factor	NG	LPG
Burner Type	80	80
Orifice	1000	260
BTU Max.	36800	26300
BTU min.	22000	17750
Kw/h	10.8k	7.7k
Chimney DIA.	4x6	4x6
Manifold Pressure[w.c]	4.7	10.4
Efficiency rate	78	82
Glass Size Length\Width	1100.5 X 620 mm	43" 5/16 X 24" 7/16'
Appliance Weigh	130Kg	285lb

## Appliance Location



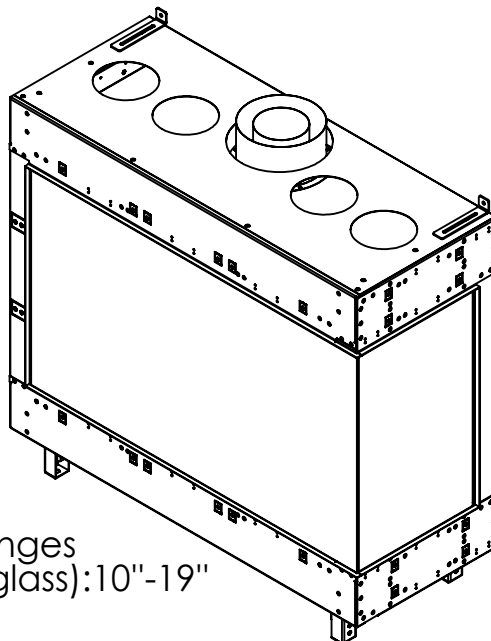
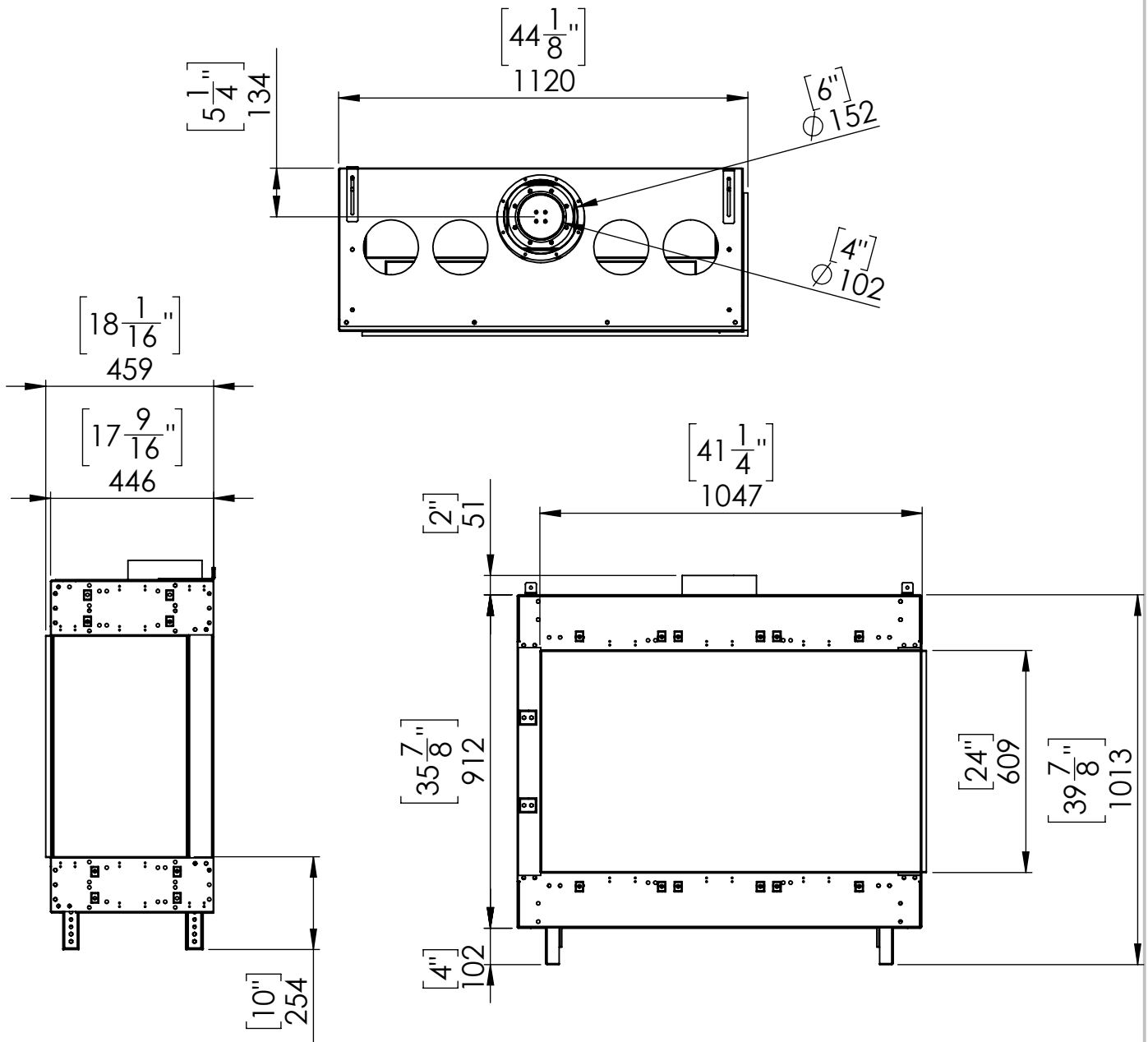

Telescopic leg ranges  
 (from bottom of glass): 10"-19"

## Flat Installation

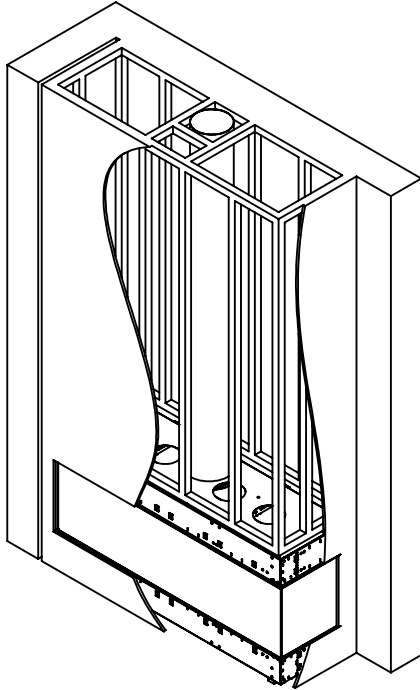

## Recess Installation

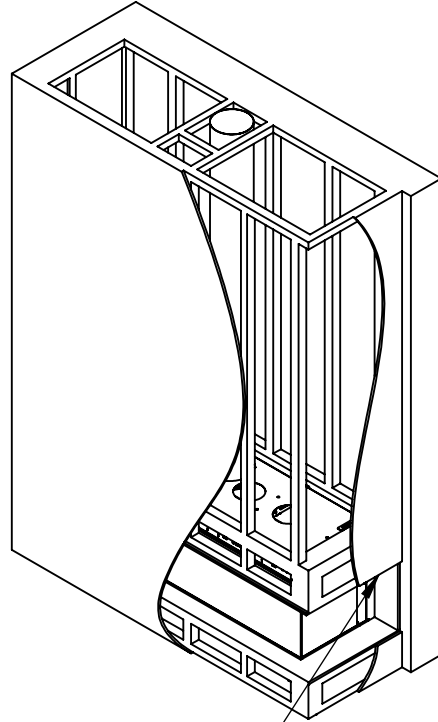

Top of Recess  
4" max

### Step 1 - Basic Framing :

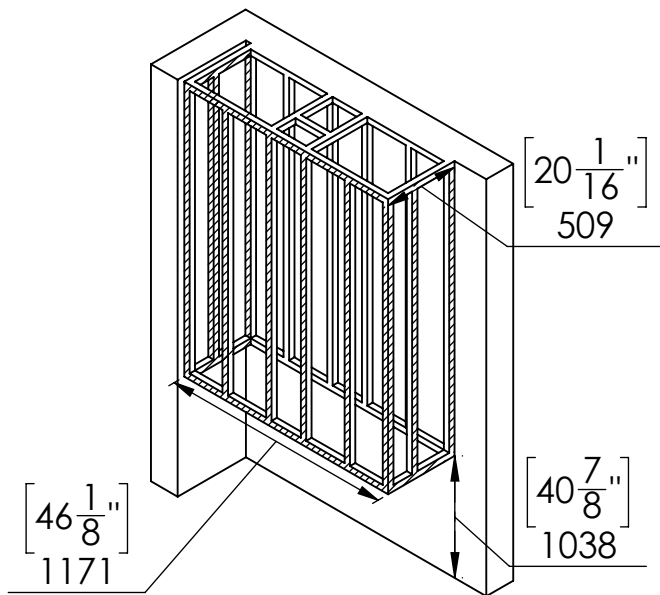

 Metal Stud

### Step 1 - Basic Framing :

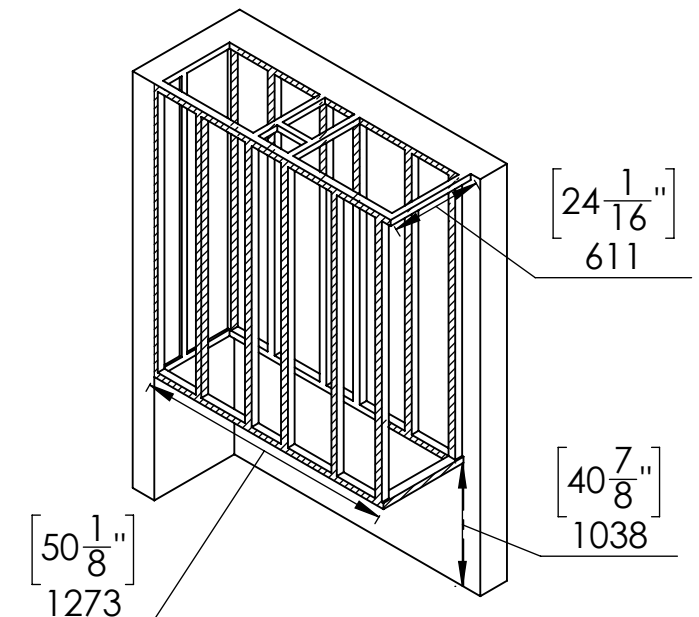

 Metal Stud

## Flat Installation

Step 2 -Positioning the Fireplace:

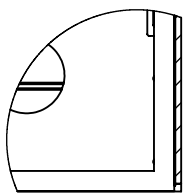
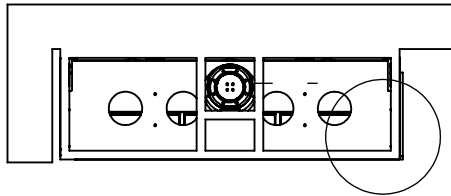

Fireplace frame finishing holder space to match wall finishing thickness

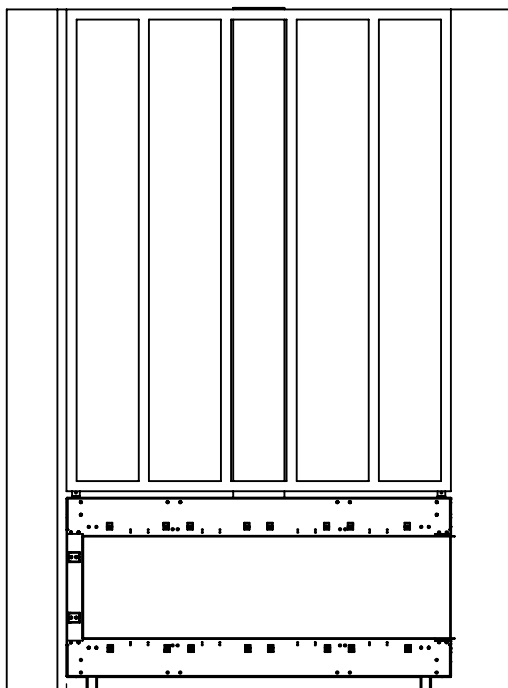

$2\frac{1}{2}''$   
63

## Recess Installation

Step 2 -Positioning the Fireplace:

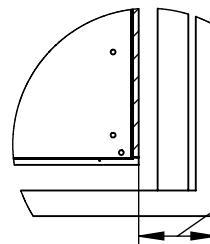
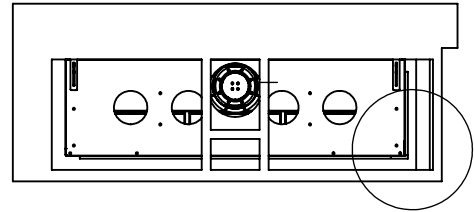

$4''$  gap to match the max. length of top shelf.  
102

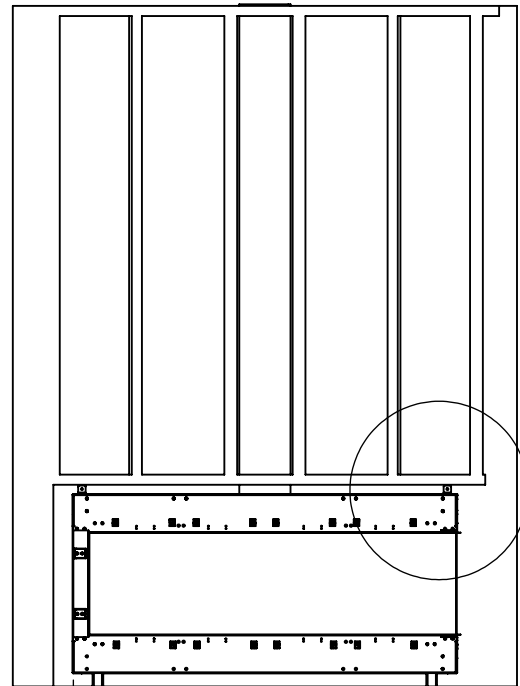

$2\frac{1}{2}''$   
63

$2''$   
51

$4''$  max.  
102 max.

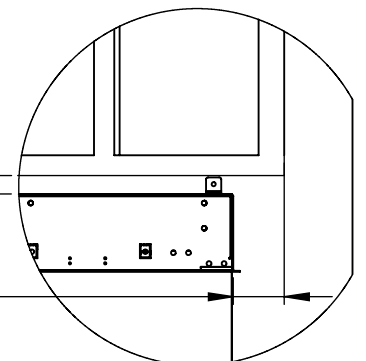

## Flat Installation

Last Step - Finishing The Fireplace Wall:

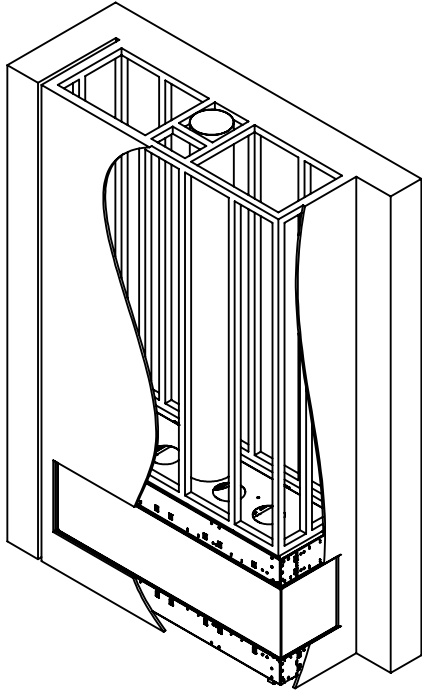

## Recess Installation

Step 3 - Framing Front Studs For Recess  
After positioning the Fireplace:

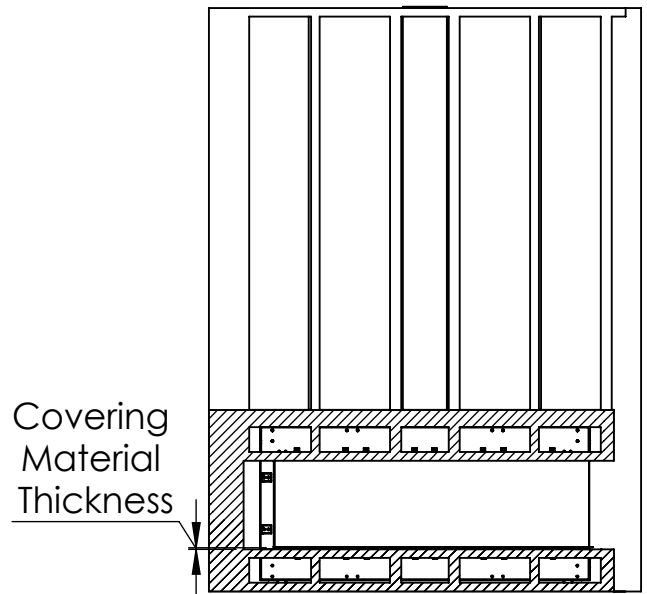

Last Step - Finishing The Fireplace Wall:

