

Front view

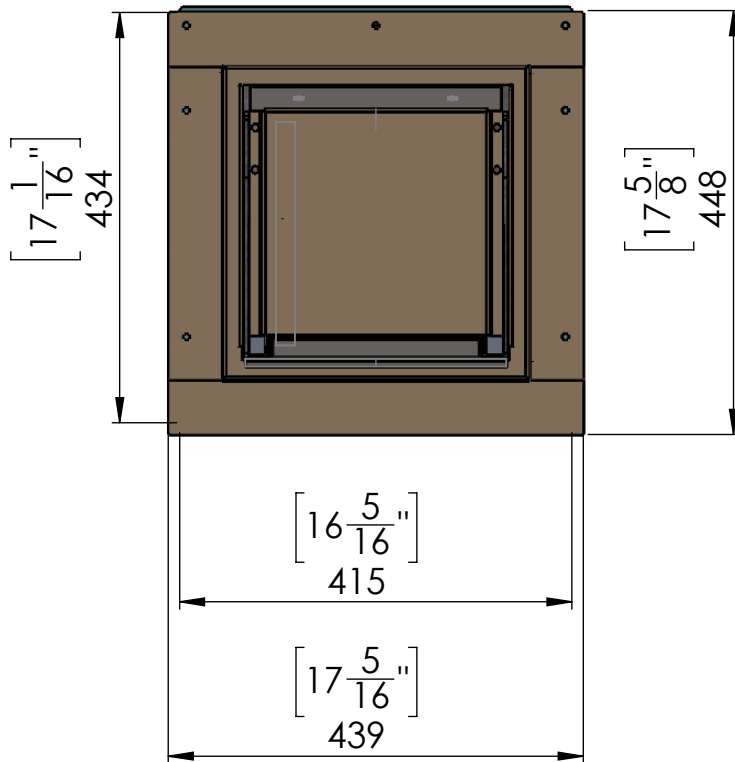

Top view

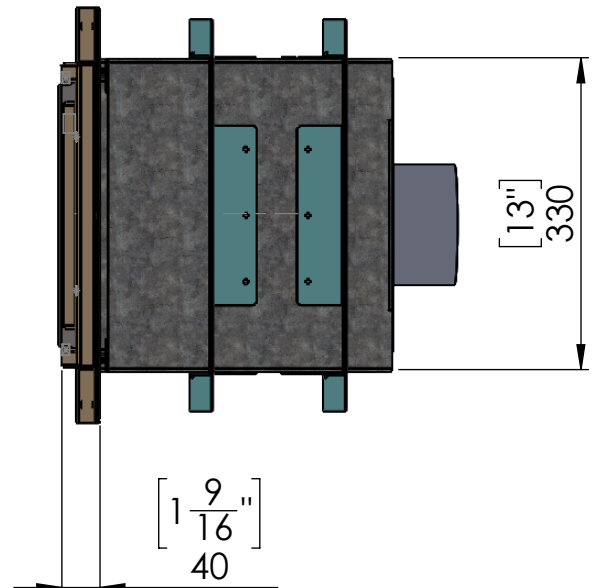

Side view

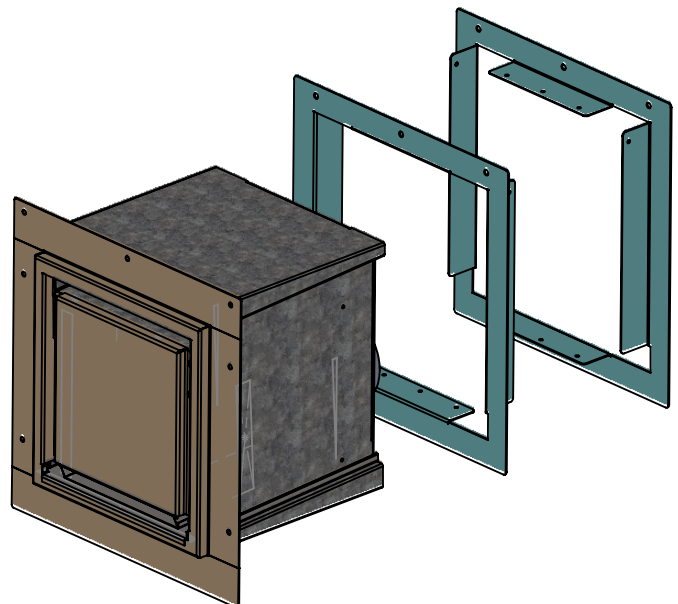
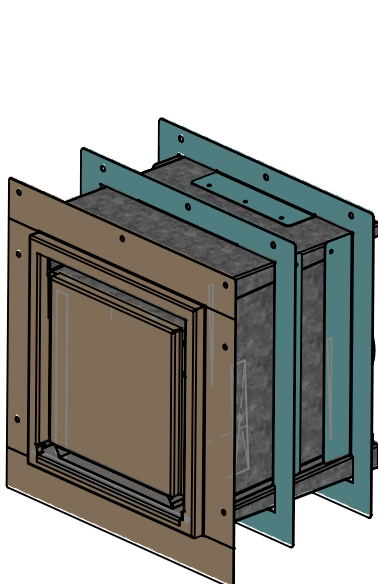
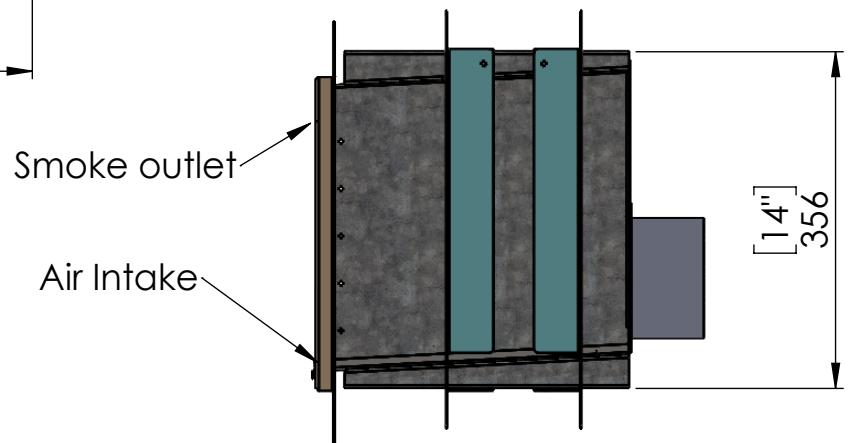

Step 1 - Basic Framing :

Construct a Hole for the fan with the measurements below:

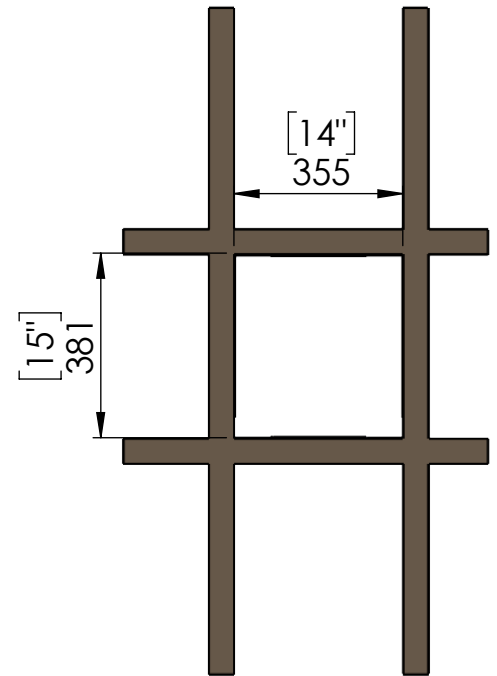
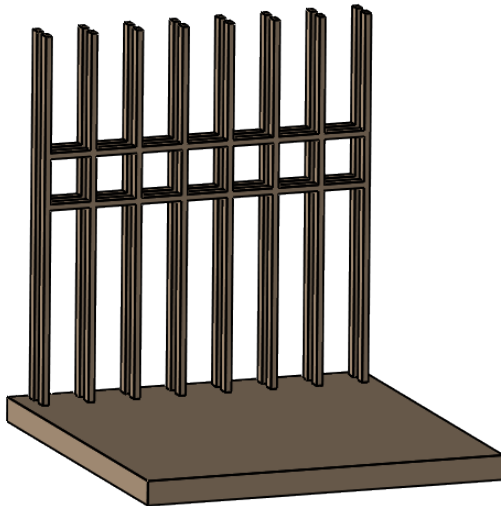

Step 2 - Connecting fan frames to main frame :

Insert the two adapters to the hole and position them in the center of hole. connect to studs using screws which fits the stud material.

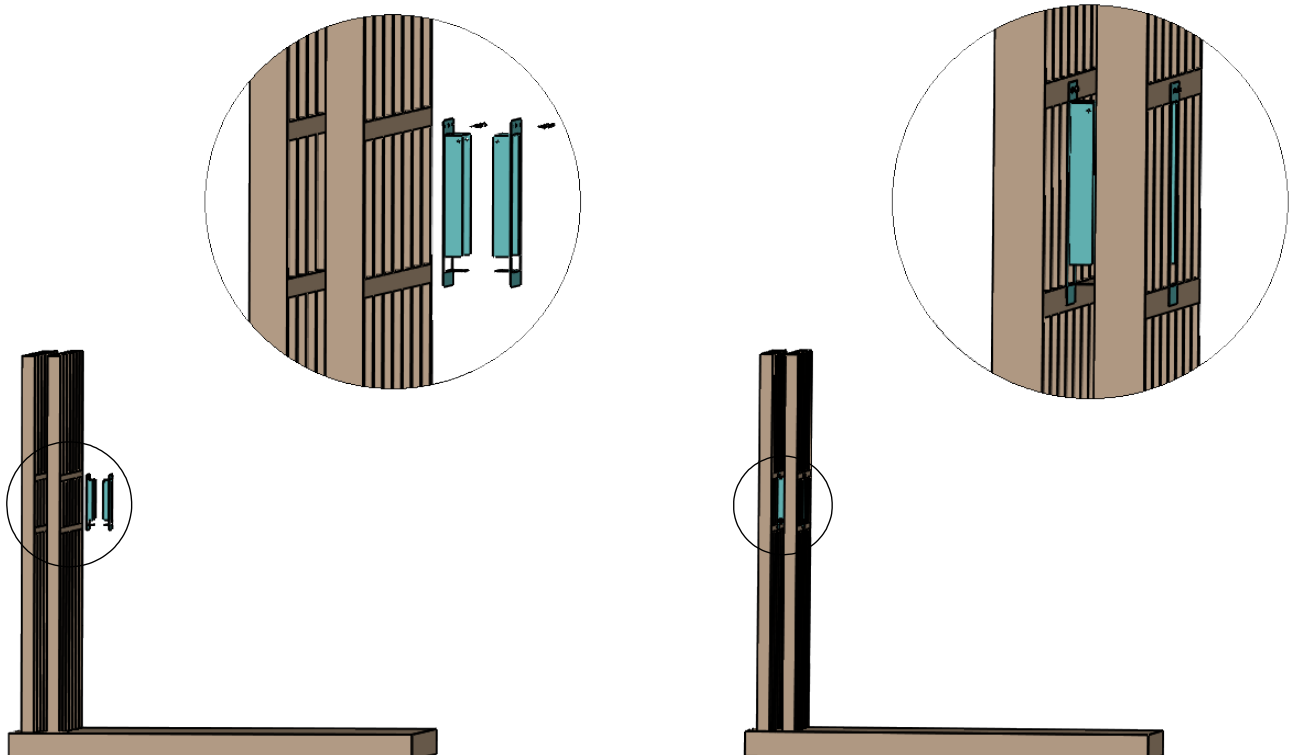

Covering steps - General view

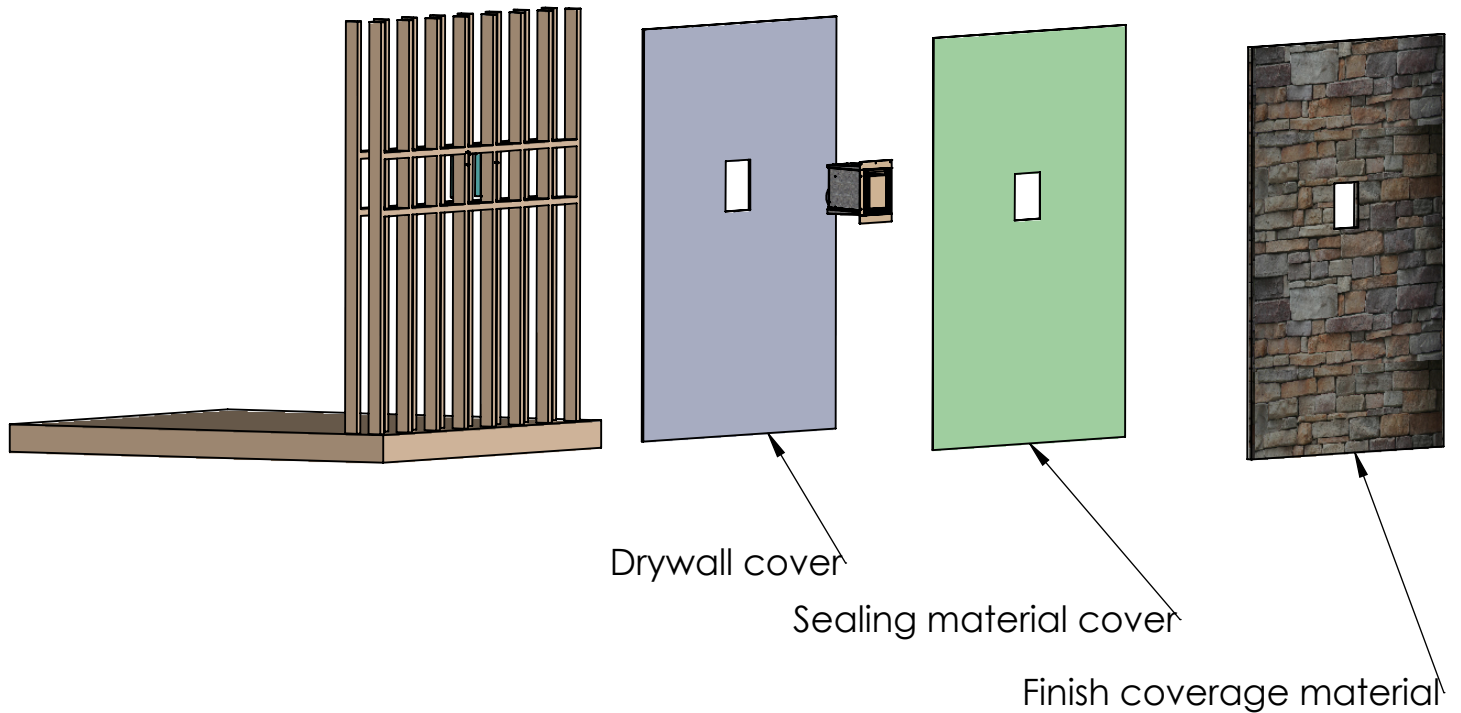

Step 3 - Covering studs with drywall and Positioning the Fan:

Make a **14" X 15"** Hole in drywall and insert Fan through hole.

Connect fan to drywall using long screws connecting drywall and studs.

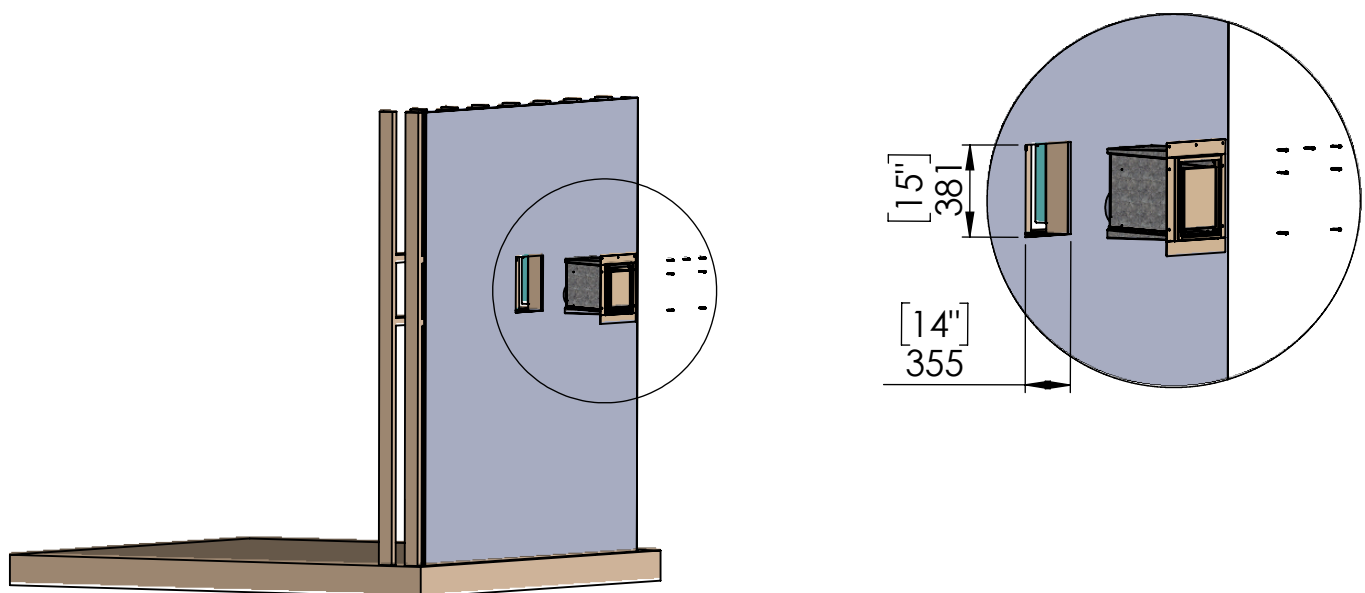

Step 4 -Covering drywall and fan-end with sealing material

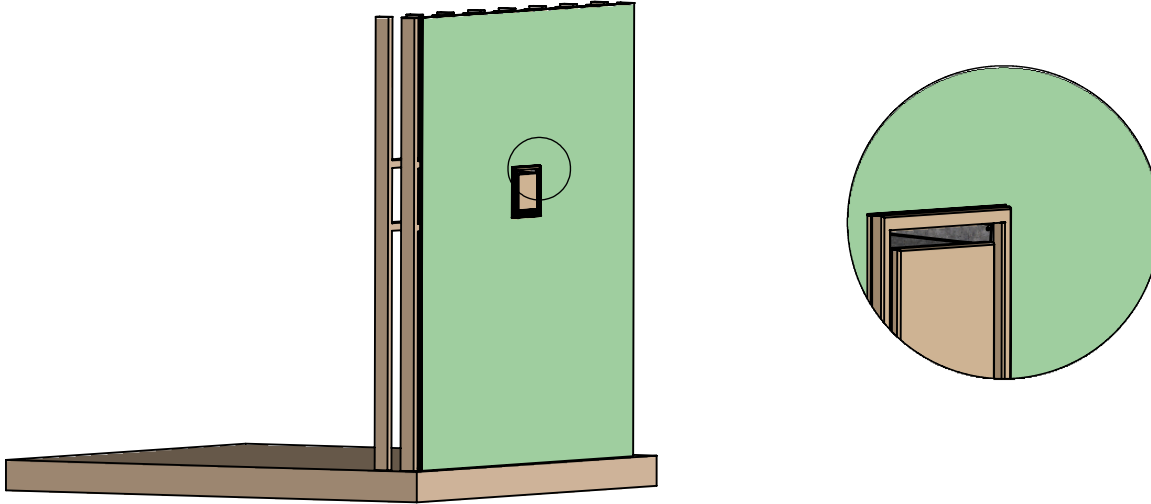

Step 5 -Cover finishing

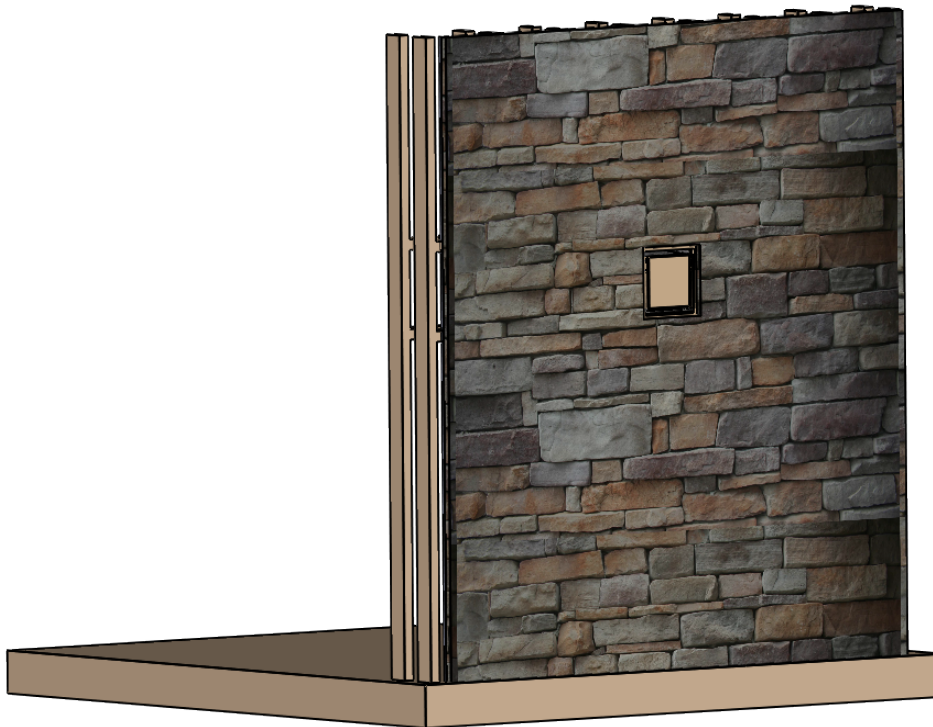

Choose your style of finishing material cover.

Confirm intake and outtake holes are vacant