

Fireplace Dimensions

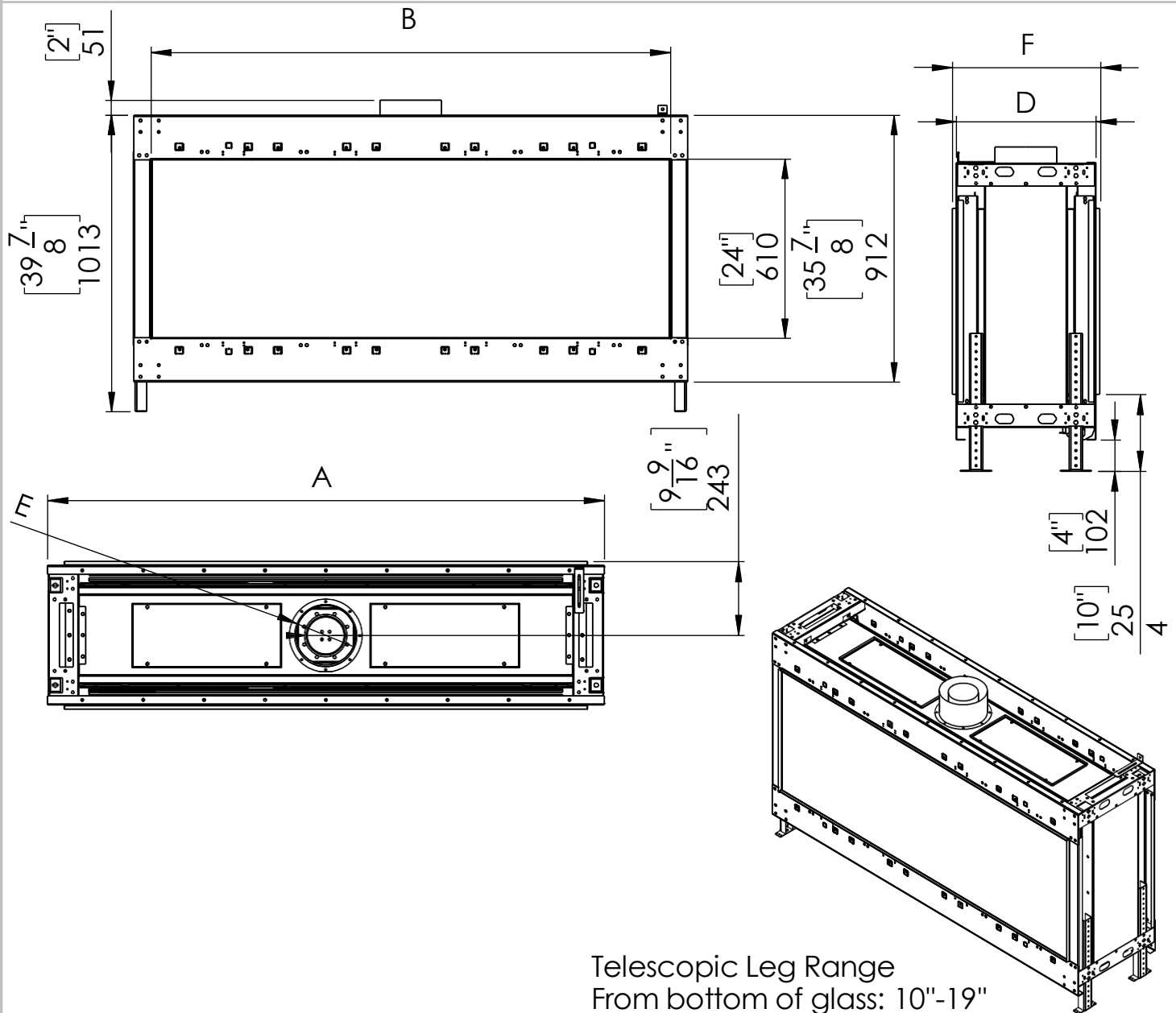

Model	45	50	60	70	80	100
A- Inch	45 9/16	52 5/16	62 2/16	71 15/16	84 9/16	101 8/16
B- Inch	41 5/16	48	57 13/16	67 11/16	80 1/16	97 3/16
F- Inch	20 4/16	20 4/16	20 4/16	20 4/16	20 4/16	20 4/16
D- Inch	19 4/16	19 4/16	19 4/16	19 4/16	19 4/16	19 4/16
E- Inch	4x6	5x8	5x8	5x8	5x8	5x8

Clearances below are to non-combustible materials.

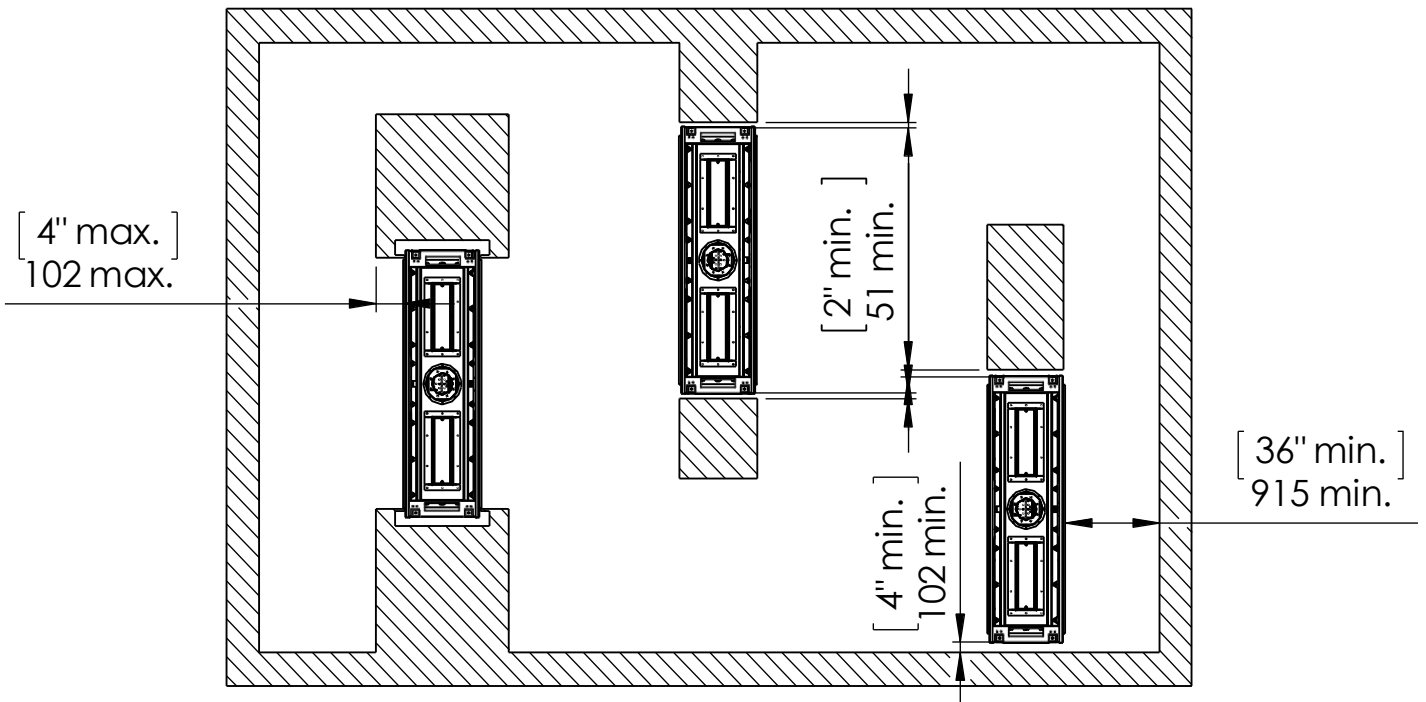

Chimney Installation

Horizontal Termination

For 5 x 8 vent size create 10" x 12" vent termination opening

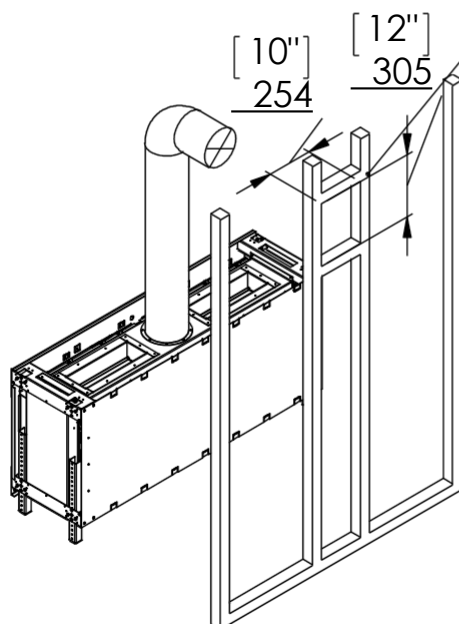

Vertical Termination

For 5 x 8 vent size create 10" x 10" vent termination opening

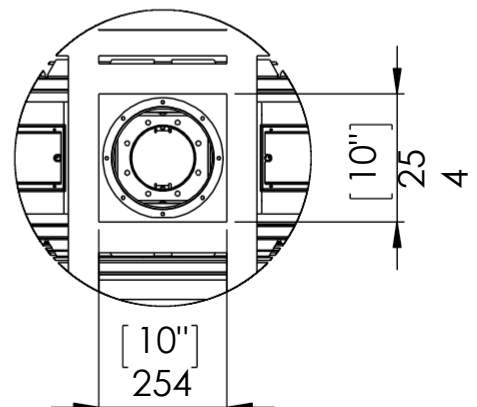
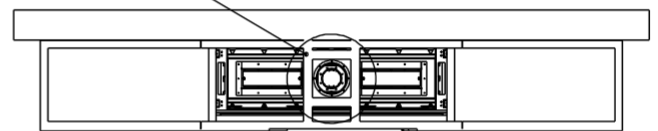

Flat Installation Example

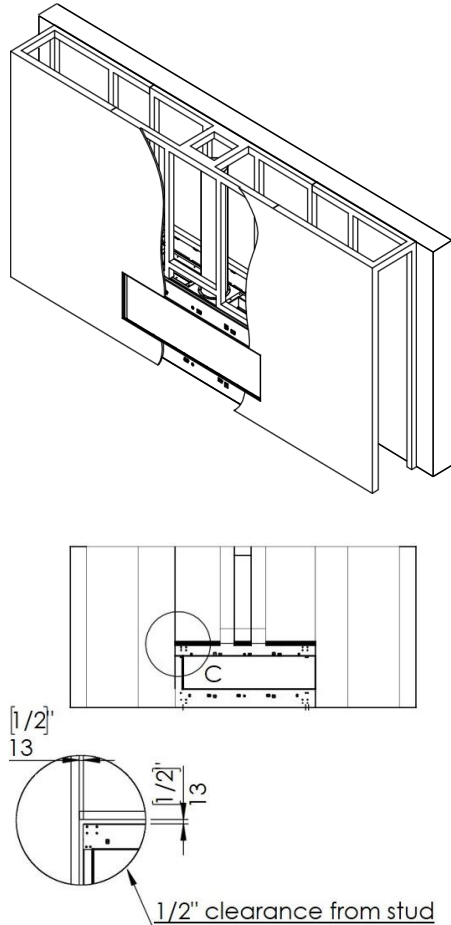

L Shape Installation Example

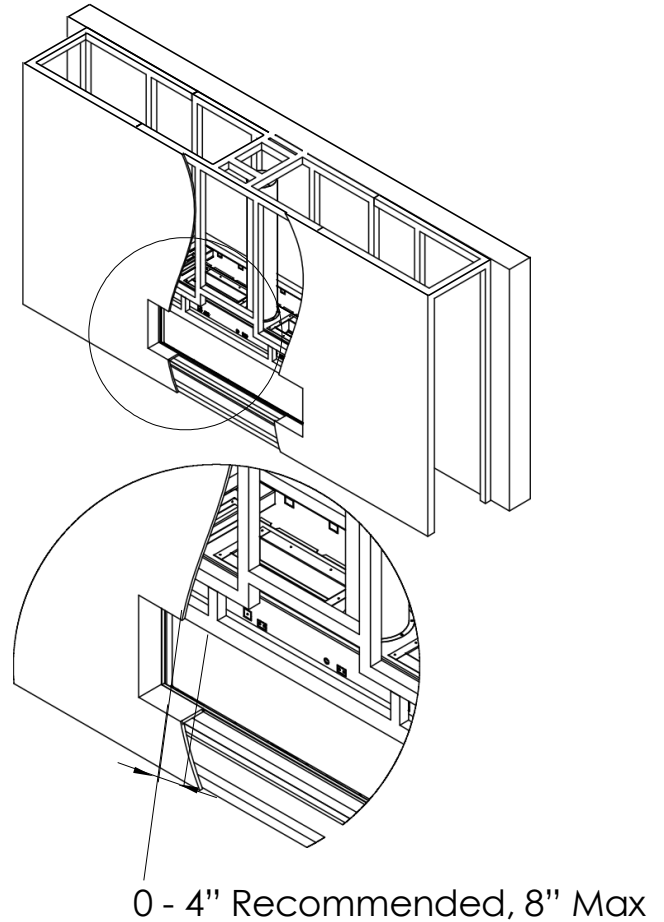

Heat Release and Air Intakes

The following sizes MUST be maintained for the upper heat release:

For fireplaces sized 80" & 100" – vent area must be at least 200 square inches.

For fireplaces sized 60" & 70" - vent area must be at least 140 square inches.

For fireplace sized 50" and below - vent area must be at least 100 square inches.

The following sizes MUST be maintained for the lower air intake:

For fireplaces sized 80" & 100" – vent area must be at least 100 square inches.

For fireplaces sized 60" & 70" - vent area must be at least 70 square inches.

For fireplaces sized 50" and below - vent area must be at least 50 square inches.

For See Through and Room Definer fireplaces, the air intake requirements are double.

NOTE: Openings above for Heat Release and Air Intake are measured for open air space.

NOTE: On all See Through and Room Definer units the air intake must be doubled

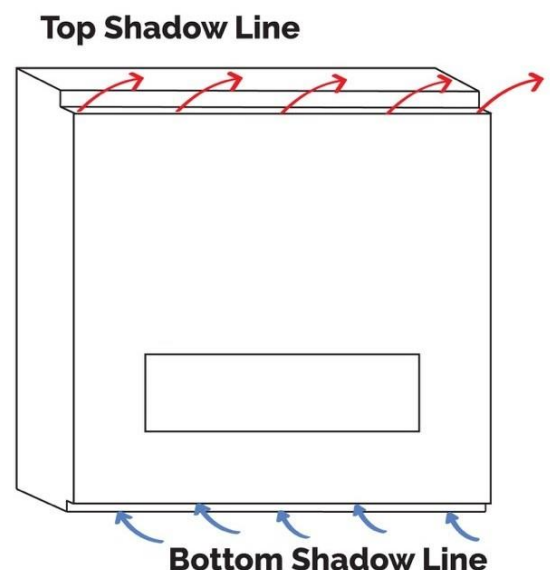

Metal Framing Dimensions

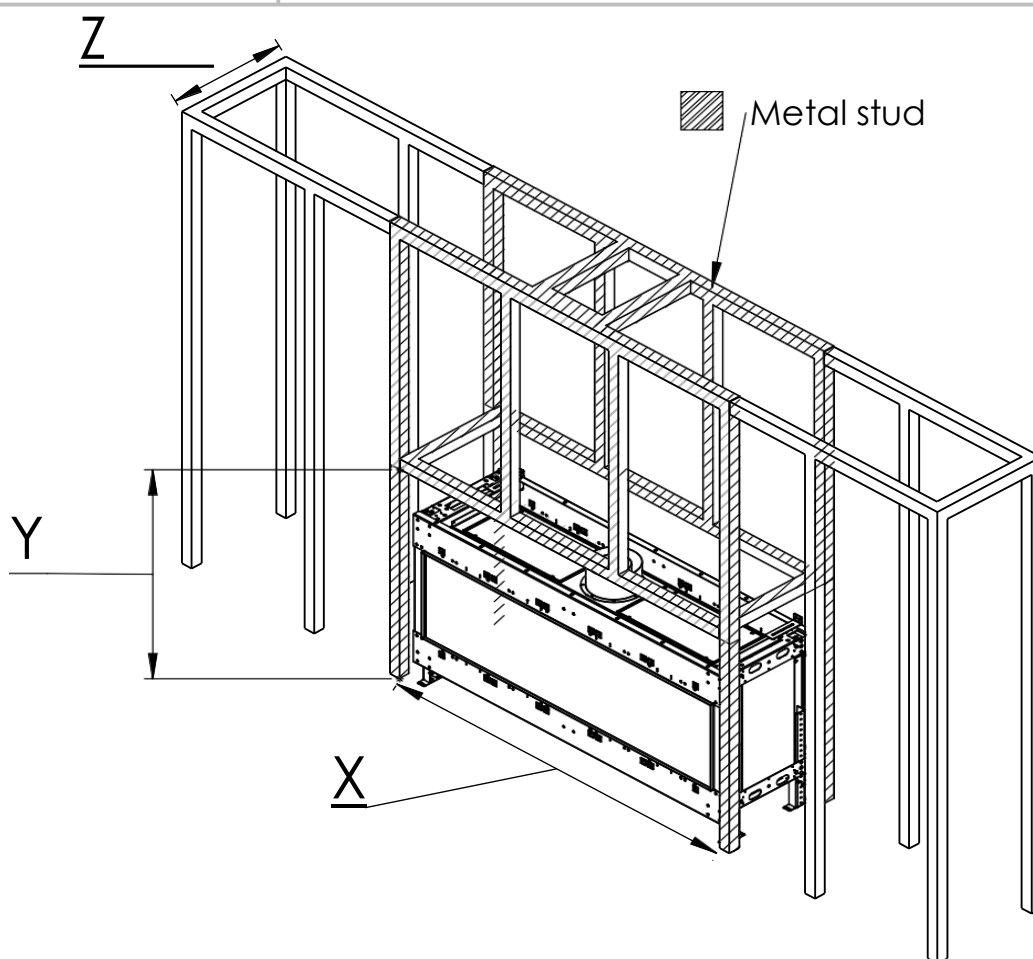

NOTE: Dimension 'Y' uses legs at default lowest height 4" below the unit with glass beginning 10" above the floor. Increase leg height and Y dimension for higher viewing window. **All framing and finishing must be secured to your projects back wall, ceiling or floor, and must never bear weight on the fireplace in any circumstance. For more information reference the [Installation Manual](#)**

		X	Y	Z	
				Flat Installation	Recess Installation (4")
45	Inch	46 ⁹ / ₁₆	40 ⁶ / ₁₆	19 ⁴ / ₁₆ "	27 ⁴ / ₁₆
	mm	1169	1026	489	692
50	Inch	53 ⁵ / ₁₆	40 ⁶ / ₁₆	19 ⁴ / ₁₆ "	27 ⁴ / ₁₆
	mm	1354	1026	489	692
60	Inch	63 ² / ₁₆	40 ⁶ / ₁₆	19 ⁴ / ₁₆ "	27 ⁴ / ₁₆
	mm	1603	1026	489	692
70	Inch	72 ¹⁵ / ₁₆	40 ⁶ / ₁₆	19 ⁴ / ₁₆ "	27 ⁴ / ₁₆
	mm	1853	1026	489	692
80	Inch	85 ⁹ / ₁₆	40 ⁶ / ₁₆	19 ⁴ / ₁₆ "	27 ⁴ / ₁₆
	mm	2173	1026	489	692
100	Inch	102 ⁸ / ₁₆	40 ⁶ / ₁₆	19 ⁴ / ₁₆ "	27 ⁴ / ₁₆
	mm	2604	1026	489	692

Materials & Clearances

MATERIALS & CLEARANCES - SIDE VIEW

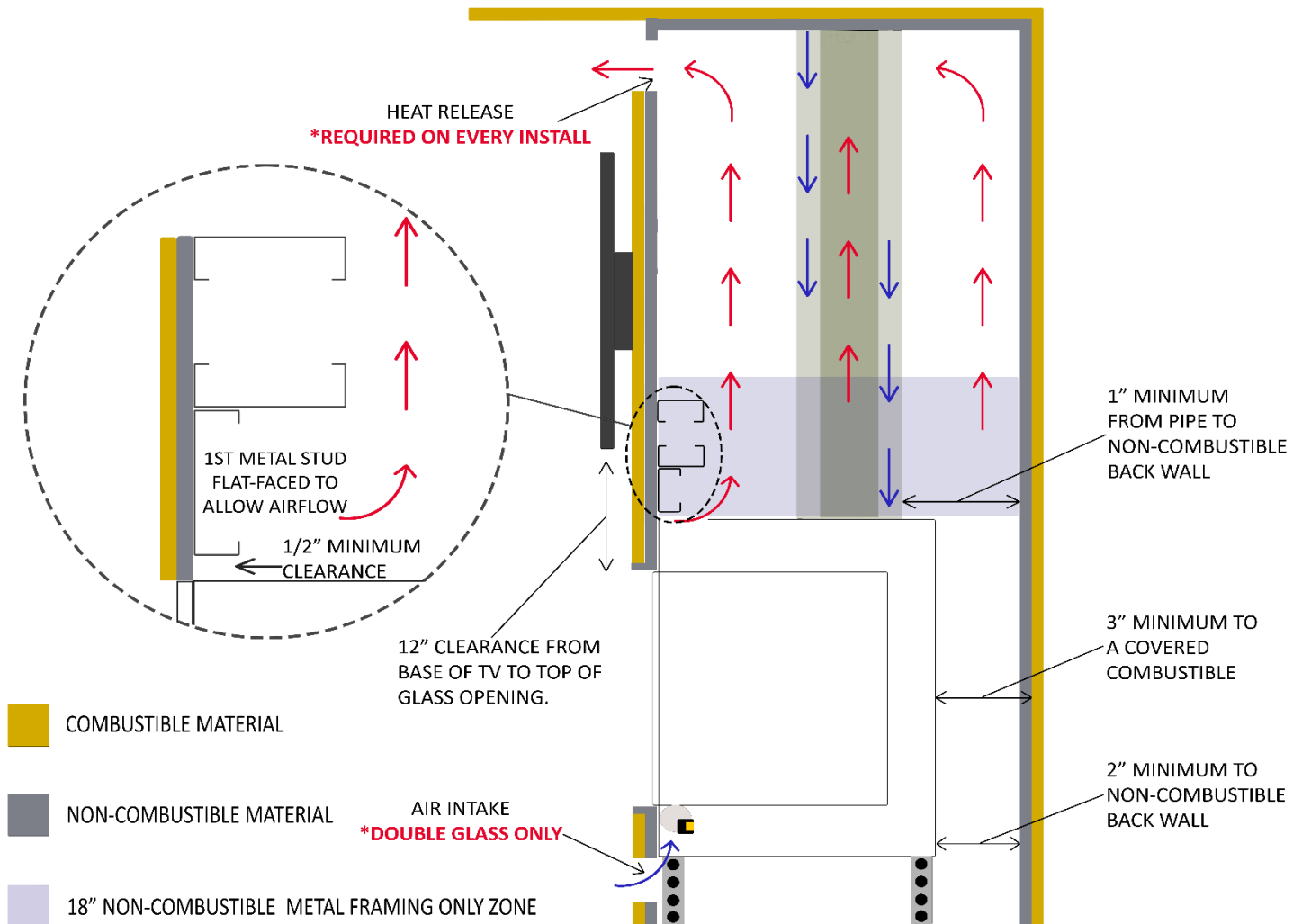

EXAMPLE OF CLEARANCES TO SIDES AND BACK

