



FLARE FIREPLACES SERVICE BULLETIN
FREE FLOW – STANDARD LOUVER INSTALLATION (V 2.1)

CSA Approved

Safety and Quality First

Service Technician Use Only

Contact Flare Fireplaces for
Support

Flare Fireplaces, LLC.

890 N Dorothy Dr.

Richardson, TX, 75081

1 (866) 639-1590

Caution: Read and understand this service bulletin thoroughly before beginning. Only a trained, and experienced service technician should attempt this procedure



FREE FLOW HEAT MANAGEMENT

Free Flow is a straightforward heat management system that pulls room air through the screen, or in the case of double or triple glass, an opening below the fireplace to cool the glass safety barrier. It then pushes the warmed air back into the room through a top release vent. Because every installation has unique framing and design requirements, these openings are typically custom designed, integrated, and finished locally.

While the ability to create your own custom intake and release still exist, to simplify the installation, Flare offers a standardized, paintable, white louver you can purchase and install to meet the necessary intake and release specifications.

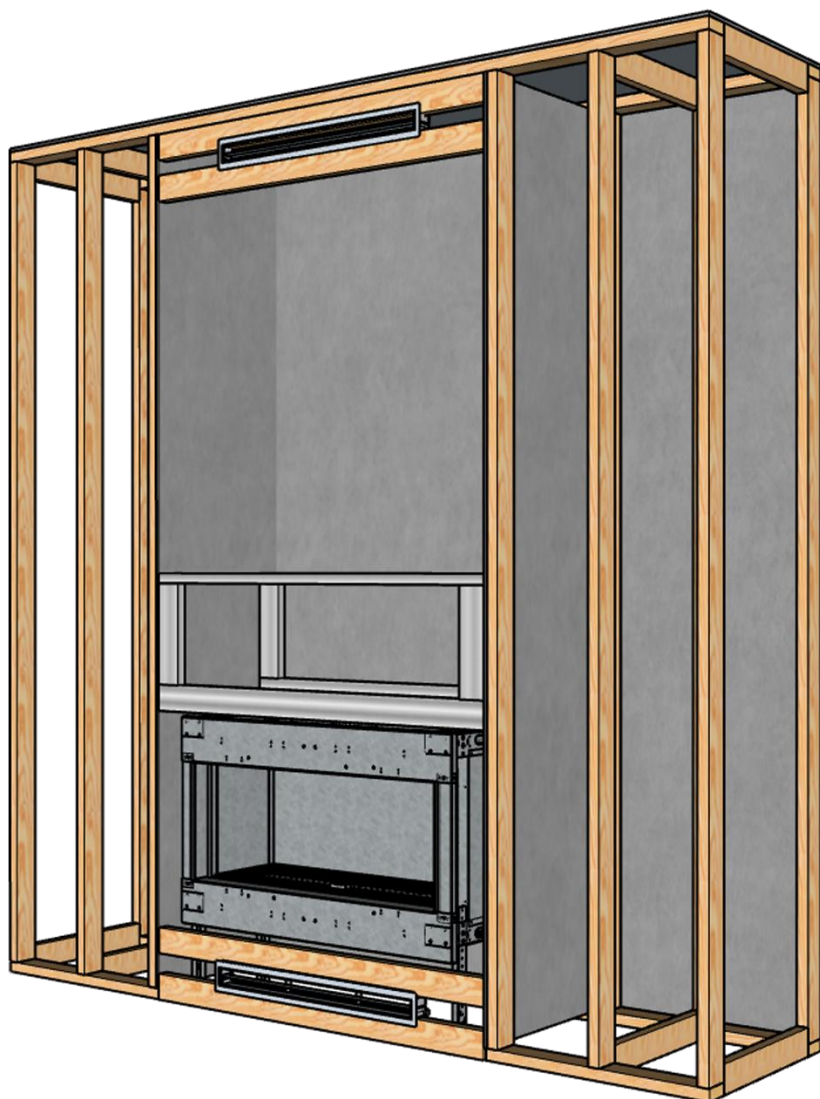



FREE FLOW SIZING CHART

Heat Release Louvers – Free Flow			
Flare Model	*Part Name	Dimension	Open Air Flow [SQ"]
Flare 30	LUV-100	46 3/64 x 2 5/32	100"
Flare 45	LUV-100	46 3/64 x 2 5/32	100"
Flare 50	LUV-100	46 3/64 x 2 5/32	100"
Traditional 42	LUV-140	64 1/2 x 2 5/32	140"
Traditional 46	LUV-140	64 1/2 x 2 5/32	140"
Passage	LUV-140	64 1/2 x 2 5/32	140"
Flare 60	LUV-140	64 1/2 x 2 5/32	140"
Flare 70	LUV-140	64 1/2 x 2 5/32	140"
Flare 80	LUV-200	92 5/32 x 2 5/32	200"
Flare 100	LUV-200	92 5/32 x 2 5/32	200"

Air Intake Louvers - Free Flow - Double or Triple Glass Only			
Flare Model	*Part Name	Dimension	Open Air Flow [SQ"]
Flare 30	LUV-50	23 1/32X2 5/32	50"
Flare 45	LUV-50	23 1/32X2 5/32	50"
Flare 50	LUV-50	23 1/32X2 5/32	50"
Traditional 42	LUV-70	32 1/4X2 5/32	70"
Traditional 46	LUV-70	32 1/4X2 5/32	70"
Passage	LUV-70	32 1/4X2 5/32	70"
Flare 60	LUV-70	32 1/4X2 5/32	70"
Flare 70	LUV-70	32 1/4X2 5/32	70"
Flare 80	LUV-100	46 3/64X2 5/32	100"
Flare 100	LUV-100	46 3/64X2 5/32	100"

*Click part name for dimension files.

NOTICE

Every indoor fireplace using the free flow system must have a heat release, but the air intake is only required for fireplaces equipped with a cool glass safety barrier.



HEAT RELEASE OPEN AIR REQUIREMENTS

The following outlines the open-air flow requirement for the free flow heat management system.

1. Must remain open at all times.
2. Must be at the top of the enclosure and within 1" – 3" of the non-combustible firestop.
3. Can be located on the front or back of the fireplace cavity
4. The heat release must be interior facing
5. The heat release may be oriented horizontally.
6. All sizing is assuming the surround stops a minimum of 40" above the fireplace
7. A non-combustible fire stop must be placed atop the inside of the chase.

Fireplaces sized **30" – 50"** the vent area must be at least **100 square inches of open-air flow**.

*Fireplaces sized **60" – 70"** the vent area must be at least **140 square inches of open-air flow**.

*Please note this includes **Traditional** and **Passage** styles as well.

Fireplaces sized **80" – 100"** the vent area must be at least **200 square inches of open-air flow**.



AIR INTAKE OPEN AIR REQUIREMENTS (REQUIRED FOR COOL GLASS ONLY)

The air intake opening is required for all fireplaces equipped with the upgraded double or triple glass safety barrier. The following outlines the open-air flow requirement for the free flow heat management system.

1. Must remain open at all times.
 2. Must be at the bottom of the enclosure and begin within 4" – 6" off the floor.
- Notes: The available height off the floor will increase to give clearance for the standardized louver.
3. Can be located on the front, back, or floor of the surround.
 5. The air intake must be interior facing
 6. The air intake must be horizontally oriented.
 8. May pull room-temp air from a space below the fireplace, like a basement or conditioned crawl space
 9. See Through and Room Definer intakes must be doubled in size and balanced evenly.

Fireplaces sized **30" - 50"** - vent area must be at least **50 square inches of open-air flow**.

See-Through and Room Definer 30"–50" vent area must be at least 100 square inches of open-air flow.

*Fireplaces sized **60" - 70"** - vent area must be at least **70 square inches of open-air flow**.

*Please note this includes **Traditional** and **Passage** styles as well.

See-Through and Room Definer 60"–70" vent area must be at least 140 square inches of open-air flow.

Fireplaces sized **80" - 100"** - vent area must be at least **100 square inches of open-air flow**.

See-Through and Room Definer 80"–100" vent area must be at least 200 square inches of open-air flow.

NOTICE

An air intake is mandatory for any fireplace fitted with a double or triple glass safety barrier. Installing the Flare standardized louver in the intake opening is optional; most projects use a custom intake design tailored to their specific framing and finish requirements. Adjustment to the fireplace height and leg positioning may be necessary.



FREE FLOW LOUVER INSTALLATION

The free flow system is comprised of two components. The inner mounting bracket and the exterior louver that gets mounted to the inner bracket to create the proper opening size.

Inner Mounting Bracket - Front View



Exterior Louver - Front View





STEP 1 – FRAMING DIMENSIONS

To prepare your fireplace cavity for the standardized louver mount follow the framing dimensions outlined below.

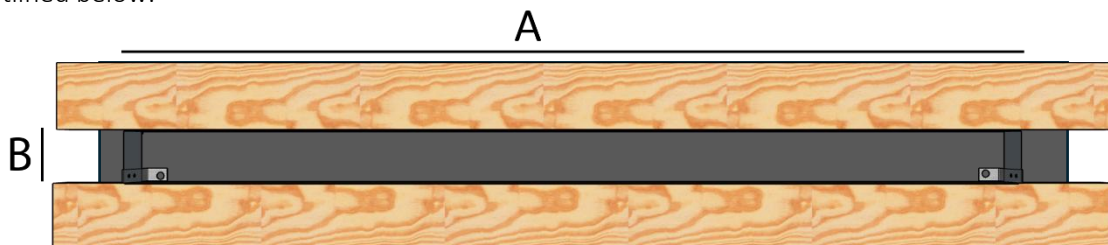

Free Flow Heat Release Framing			
Model	Louver	*A	B
30"	LUV100	48"	2 13/16"
45"			
50"			
Traditional 42	LUV140	66 1/2"	2 13/16"
Traditional 46			
Passage			
60"			
70"			
80"	LUV200	80"	2 13/16"
100"			

Free Flow Air Intake Framing - Double or Triple Glass Only			
Model	Louver	*A	B
30"	LUV50	25"	2 13/16"
45"			
50"			
Traditional 42	LUV70	33 13/16"	2 13/16"
Traditional 46			
Passage			
60"			
70"			
80"	LUV100	48"	2 13/16"
100"			

*A represents the minimum width required to house the louver's mount.



STEP 2 – INSTALLING INNER MOUNTING BRACKET

Screw the inner mounting bracket to the back of the wood framing using the holes on the upper and lower mounting flanges (circled in red below) viewed from inside the framing.

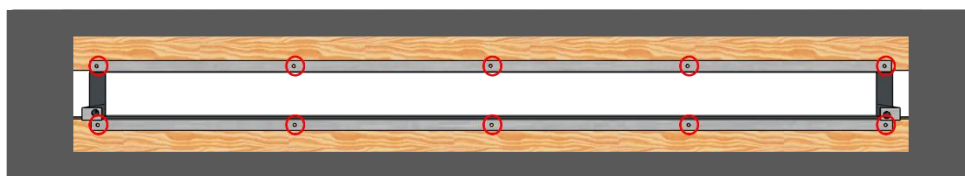

INSIDE OF FRAMING VIEW

STEP 3 – ATTACHING LOUVER TO MOUNT

The louver then gets placed inside the inner stud-mounted bracket and is secured with screws using the mounting points circled in red below.

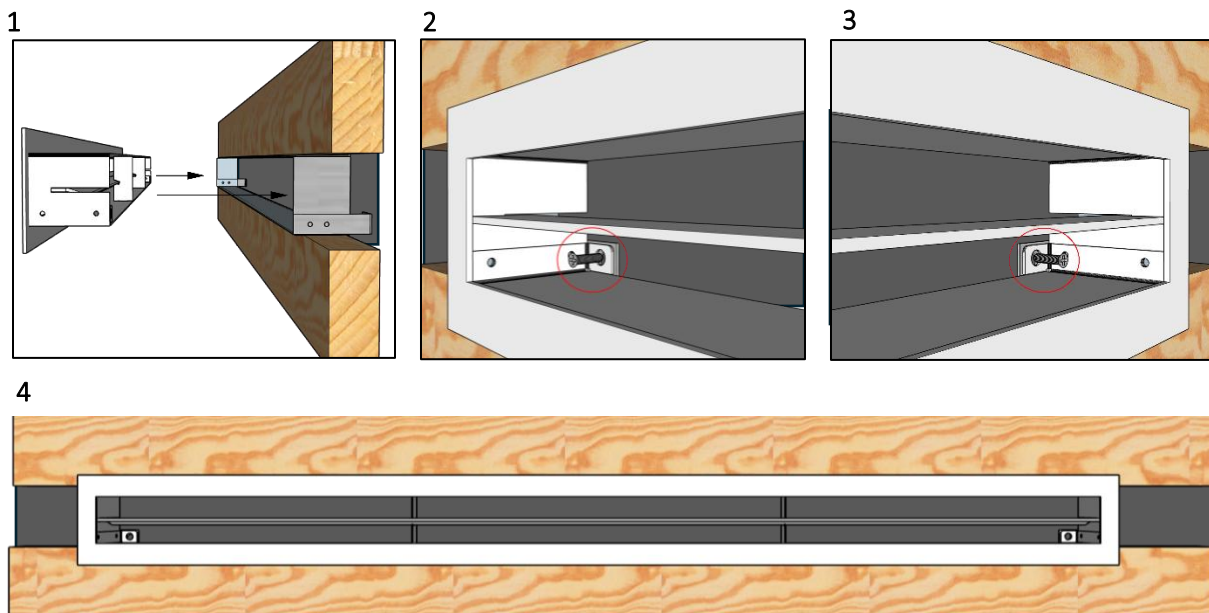

NOTICE

The upper and lower mounting studs for framing the heat release and air intake sit on edge.



PARTS LIST AND SKUS

Free Flow - Heat Release			
Model Size	Part Name	Description	SKU
Flare 30	LUV-100	100 SQ" Open Air Flow	LUV100
Flare 45	LUV-100	100 SQ" Open Air Flow	LUV100
Flare 50	LUV-100	100 SQ" Open Air Flow	LUV100
Traditional 42	LUV-140	140 SQ" Open Air Flow	LUV140
Traditional 46	LUV-140	140 SQ" Open Air Flow	LUV140
Passage	LUV-140	140 SQ" Open Air Flow	LUV140
Flare 60	LUV-140	140 SQ" Open Air Flow	LUV140
Flare 70	LUV-140	140 SQ" Open Air Flow	LUV140
Flare 80	LUV-200	200 SQ" Open Air Flow	LUV200
Flare 100	LUV-200	200 SQ" Open Air Flow	LUV200

Free Flow - Air Intake - Double or Triple Glass Only			
Model Size	Part Name	Description	SKU
Flare 30	LUV-50	50 SQ" Open Air Flow	LUV50
Flare 45	LUV-50	50 SQ" Open Air Flow	LUV50
Flare 50	LUV-50	50 SQ" Open Air Flow	LUV50
Traditional 42	LUV-70	70 SQ" Open Air Flow	LUV70
Traditional 46	LUV-70	70 SQ" Open Air Flow	LUV70
Passage	LUV-70	70 SQ" Open Air Flow	LUV70
Flare 60	LUV-70	70 SQ" Open Air Flow	LUV70
Flare 70	LUV-70	70 SQ" Open Air Flow	LUV70
Flare 80	LUV-100	100 SQ" Open Air Flow	LUV100
Flare 100	LUV-100	100 SQ" Open Air Flow	LUV100

*Click SKUS for ordering replacement parts.